

DIN 1025 TI.4 1964

Odpovídající normy:

DIN EN: 10025:91
Euronorm (EU): 53:62
TDP: PN-91/H-93010
ČSN není

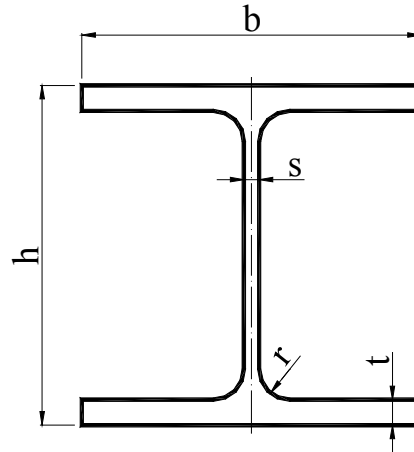

Označení HEM	Jednotlivé rozměry [mm]					Průřez cm ²	Hmotnost kg/m
	h	b	s	t	r		
100	120	106	12,0	20,0	12	53,2	41,8
120	140	126	12,5	21,0	12	66,4	52,1
140	160	146	13,0	22,0	12	80,6	63,2
160	180	166	14,0	23,0	15	97,1	76,2
180	200	186	14,5	24,0	15	113	88,9
200	220	206	15,0	25,0	18	131	103,0
220	240	226	15,5	26,0	18	149	117,0
240	270	248	18,0	32,0	21	200	157,0
260	290	268	18,0	32,5	24	220	172,0
280	310	288	18,5	33,0	24	240	189,0
300	340	310	21,0	39,0	27	303	238,0
320	359	309	21,0	40,0	27	312	245,0
340	377	309	21,0	40,0	27	316	248,0
360	395	308	21,0	40,0	27	319	250,0
400	432	307	21,0	40,0	27	326	256,0
450	478	307	21,0	40,0	27	335	263,0
500	524	306	21,0	40,0	27	344	270,0
550	572	306	21,0	40,0	27	354	278,0
600	620	305	21,0	40,0	27	364	285,0
650	668	305	21,0	40,0	27	374	293,0
700	716	304	21,0	40,0	27	383	301,0
800	814	303	21,0	40,0	30	404	317,0
900	910	302	21,0	40,0	30	424	333,0
1000	1008	302	21,0	40,0	30	444	349,0